

پانٲھيون

PANTHEON

DEVELOPMENT



Back in 2016, we started something special. Pantheon Development was born with one big idea: to shake up the real estate scene in the UAE and bring affordable luxury to Dubai's residential sector. We spotted a gap in the market for high-quality, luxury properties that didn't break the bank, and we jumped right in. Our hard work and dedication haven't gone unnoticed. In 2019, we bagged the "Best Affordable Luxury Property" award at the Arabian Business Real Estate Awards. A solid thumbs-up for our tireless efforts to excel in Dubai's affordable luxury sector. Here at Pantheon Development, we're more than just a real estate developer. We're shaping the way we live and bringing our beliefs to life. We're firmly on track to grow our share in Dubai's affordable luxury sector, launch more projects, and make a positive impact on the local real estate market. We're all about delivering luxury you can afford, without skimping on quality - that's the Pantheon promise.

بانثيون  
**PANTHEON**  
DEVELOPMENT

# Ongoing Projects



# Upcoming Projects



Completed  
Projects

## Pantheon Boulevard

**Status:** 100%  
sold &  
handover

**Launch Year:**  
2016

**Completion  
Year:** 2018

**Units:** 162

**Project Value  
(AED)(Mn):**  
150

## Pantheon Elysee I

**Status:** 100%  
sold &  
handover

**Launch Year:**  
2018

**Completion  
Year:** 2020

**Units:** 272

**Project Value  
(AED)(Mn):**  
185

## Pantheon Elysee II

**Status:** 100%  
sold &  
handover

**Launch Year:**  
2021

**Completion  
Year:** 2022

**Units:** 162

**Project Value  
(AED)(Mn):**  
92

## Pantheon Elysee III

**Status:** 100%  
sold &  
handover

**Launch Year:**  
2021

**Completion  
Year:** 2024

**Units:** 322

**Project Value  
(AED)(Mn):**  
201

## Pantheon Elysee Heights

**Status:** 100%  
sold &  
handover

**Launch Year:**  
2023

**Completion  
Year:** 2026

**Units:** 193

**Project Value  
(AED)(Mn):**  
150

## Pantheon Maison Elysee I

**Status:**  
Launch

**Launch Year:**  
Nov, 2023

**Completion  
Year:** 2027

**Units:** 351

**Project Value  
(AED)(Mn):**  
300

## Pantheon Maison Elysee II

**Status:**  
Launch

**Launch Year:**  
Feb, 2024

**Completion  
Year:** 2027

**Units:** 351

**Project Value  
(AED)(Mn):**  
300

## Pantheon Maison Elysee III

**Status:**  
Upcoming

**Launch Year:**  
June, 2024

**Completion  
Year:** 2028

**Units:** 350

**Project Value  
(AED)(Mn):**  
330

# Project Status & Achievement

■ Units ■ Project Value (AED) (Mn)

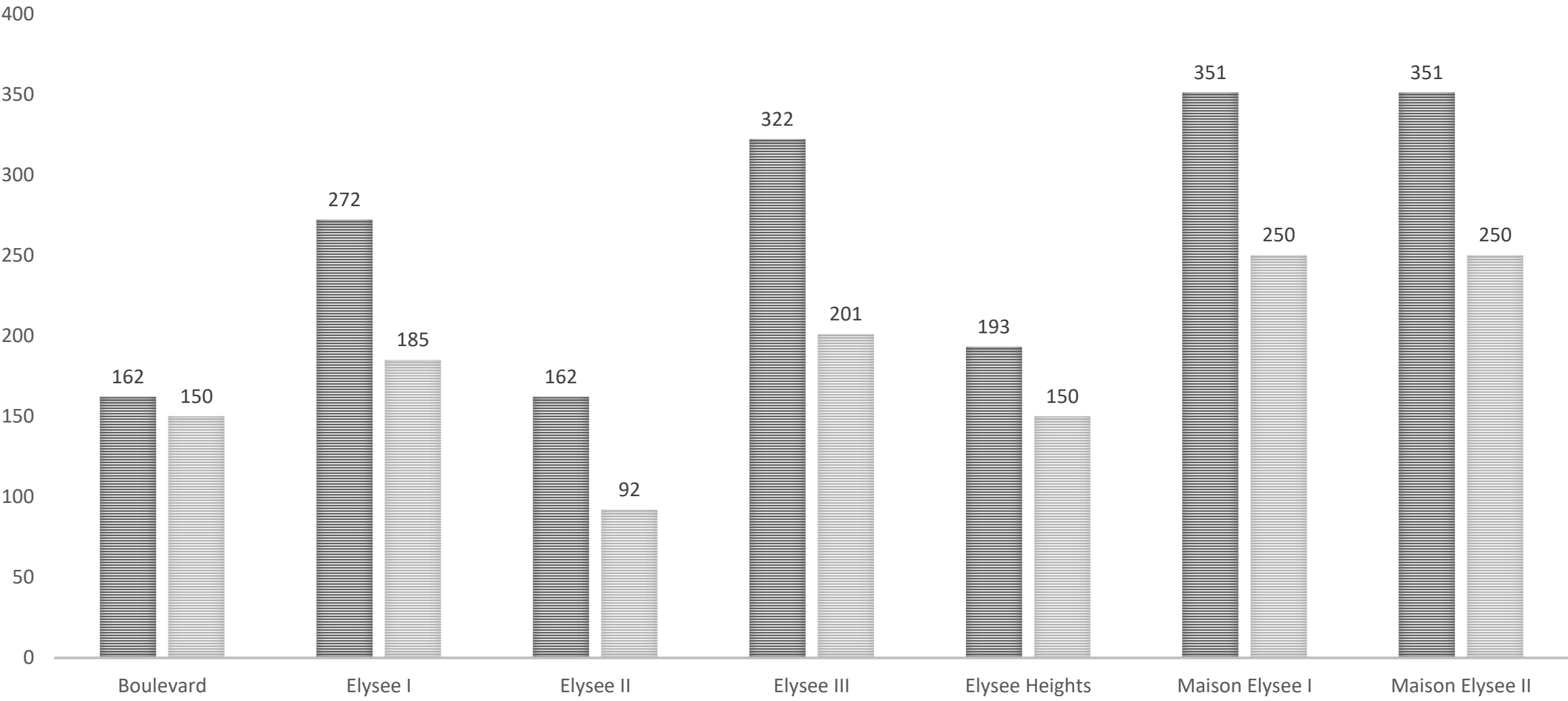

# Innovative Real Estate Development Model

## Development cum Financial Model

### Deferred Payment:

48% upfront, balance over 3-5 years.  
EMI equal to monthly rent.

### Ownership Model

Developer retains ownership until full payment is received.

## Performance & Reliability

**RERA Compliance:** No customer complaints

**Sales Milestone:** Over 1500 units sold in the last 5 years

**Timely Delivery:** Before schedule, even during COVID-19

## Our Strategic Advantages

**Solid Financials:** Strong profitability and cash flow

**Leadership Excellence:** Award-winning team, 20+ staff, 30+ sales, 700+ brokers.

**Market-Ready:** Clear strategy for first-time buyers/investors in affordable luxury, with favorable payment plans.

# Pantheon Maison Elysee II

Introducing Maison Elysee 2, a gem in District 12's crown, crafted under the guiding principles of "The Pantheon Philosophy." This prestigious development reflects our unwavering commitment to not just meet, but exceed the aspirations of our discerning clientele. Encompassing a total of 351 meticulously designed units, Maison Elysee 2 offers an array of studio, 1, and 2-bedroom apartments, accompanied by exclusive retail experiences.

The intricate textures and modern aesthetics of each residence at Maison Elysee 2 have been intentionally curated to stand out with effortless sophistication. These homes are more than mere living spaces – they are sculpted environments that offer both grace and functionality in equal measure. At Maison Elysee 2, you don't just reside; you revel in a lifestyle that epitomizes the essence of contemporary elegance.



# Pantheon Maison Elysee I

Elevating the pinnacle of urban living, Maison Elysee 1 emerges as our grandest vision realized in the heart of District 12, JVC. Embodied by "The Pantheon Philosophy," this architectural marvel surpasses every expectation, presenting a collection of 351 exquisite units. Choose from a refined selection of studio, 1, and 2-bedroom apartments, each space a testament to functionality wrapped in elegance.

The interiors are a dialogue between fine textures and state-of-the-art design, ensuring that every corner of your abode in JVC resonates with luxury and practical beauty. Maison Elysee 1 is not just a residence but a canvas of high-end living, waiting for you to imprint your story.



# Pantheon Elysee Heights

Our newest, and tallest, real estate development to date, the Pantheon Elysee Heights is designed and structured on “The Pantheon Philosophy” that is all about finding solutions to exceed the needs and expectations of customers. The development comprises of a total of 193 Units which is a combination of studio, 1 & 2 Bedroom Apartment along with 10 retail outlets.

Rich textures, and contemporary style, the exceptional features of your new home in JVC has been carefully selected to be beautiful, functional, and elegant on their own. All are combined into a symphony of fine design



# Pantheon Elysee III

Our largest, real estate development to date, the Pantheon Elysee III is designed and structured on “The Pantheon Philosophy” that is all about finding solutions to exceed the needs and expectations of customers. The development comprises of a total of 322 Units which is a combination of studio, 1 & 2 Bedroom Apartment along with 12 retail outlets.

Rich textures, and contemporary style, the exceptional features of your new home in JVC has been carefully selected to be beautiful, functional, and elegant on their own. All are combined into a symphony of fine design



# Pantheon Elysee II

Following the project Elysee I, Elysee II by Pantheon is a property that values functionality as much as aesthetics. It is designed with a believe in creating spaces that enable people to live better lives, which is why we craft homes with meticulous attention to every last detail.

The development comprises of a total of 162 residential units which is a combination of studio, 1 & 2 Bedrooms Apartment and a 4 bedroom Penthouse.

Pantheon Elysee II, luxury apartments in JVC have been designed for a carefree lifestyle for someone who has everything one could desire; high-end apartment features, many community perks, the use of state-of-the-art facilities. It features a 'sleek and modern aesthetic design that is preferred by many urbanities.

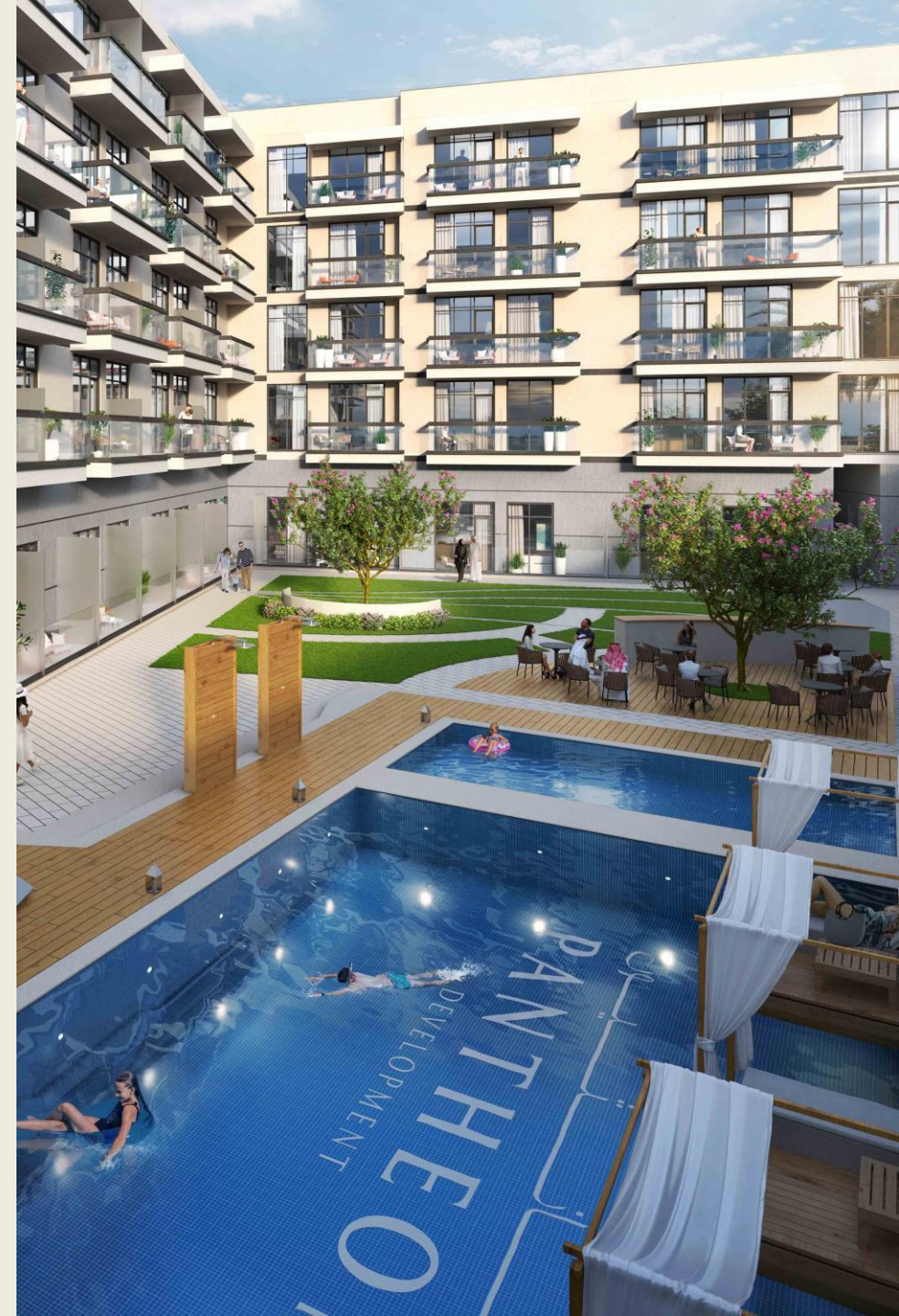

# Pantheon Elysee I

Pantheon Elysee I structure was designed with the sleek, modern aesthetic that is preferred by many urbanites. The Pantheon Elysee I community offered 266 residential units, and 6 spacious retail outlets on the ground floor.

A combination of studio, 1, 2 and 3 Bedrooms Apartment. This stylish and sophisticated structure will stand out among the other residences with its clean, crisp lines and meticulous attention to every single architectural detail. A manifestation of sophistication, it entreats passers-by to take a closer look. With its impeccable design and prime location in the Jumeirah Village Circle, don't be surprised if people stop and stare.



# Pantheon Boulevard

Pantheon Boulevard is a ready to move-in Spanish style 5-storey building situated in District 13 of Jumeirah Village Circle. The complex has 157 well-designed Studios, 1- Bedroom & 2-Bedroom apartments and 5 retail outlets, all artistically designed to provide the comfort of fine living and also make the best use of space, so you get to use that extra space including private balconies to enjoy peaceful early morning cups of coffee before you start your day.

The Pantheon Boulevard presents 3 different types of Studios, 8 different types of elegantly designed 1-bedroom apartments and 7 types of 2 bedroom apartments for people needing that extra bedroom. When you live at Pantheon Boulevard, you are never too far away from the business district of Dubai and the burgeoning glamor of the new Dubai South.





بانثيون  
**PANTHEON**  
DEVELOPMENT

## Contact Us

Pantheon Development Head  
Office  
1st Floor, Lamborghini Building,  
Sheikh Zayed Road, Dubai - UAE  
P.O. Box 336709  
Telephone: +97145235235  
[www.pantheondevelopment.ae](http://www.pantheondevelopment.ae)